

North Augusta



South Carolina's Riverfront

MINUTES OF JANUARY 4, 2021

Robert A. Pettit, Mayor

*J. Robert Brooks, Councilmember
Pat C. Carpenter, Councilmember
Fletcher L. Dickert, Councilmember
David W. McGhee, Councilmember
Eric H. Presnell, Councilmember
Kevin W. Toole, Councilmember*

ORDER OF BUSINESS

VIRTUAL STUDY SESSION

The virtual study session for the City Council meeting of the City of North Augusta of January 4, 2021, having been duly publicized, was called to order by Mayor Pettit at 6:03 p.m. and streamed online for public viewing at the City Facebook page: "City of North Augusta – Public Information" and City YouTube page: "City of North Augusta Public Information." The study session adjourned at 7:01 p.m.

Per Section 30-4-80(e) notice of the meetings was sent out by email to the current maintained "Agenda Mailout" list consisting of news media outlets and individuals or companies requesting notification. Notice of the meetings was also posted on the outside doors of the Municipal Center, the main bulletin board of the Municipal Center located on the first floor, and the City of North Augusta website.

Members present were Mayor Pettit, Councilmembers Brooks, Carpenter, Dickert, McGhee, Presnell, and Toole.

Also in attendance were James S. Clifford, City Administrator; Rachelle Moody, Assistant City Administrator; Kelly F. Zier, City Attorney; Cammie T. Hayes, Director of Finance and General Services; John C. Thomas, Director of Public Safety; Thomas C. Zeaser, Director of Engineering and Public Works; Richard L. Meyer, Director of Parks, Recreation, and Tourism; Lillian E. (Libby) Hodges, Director of Planning and Development; Ricky Jones, Manager of Information Technology and Sharon Lamar, City Clerk.

ITEM 1. CITY COUNCIL AGENDA: Items on the January 4, 2021 Council Agenda- Council Discussion

City Administrator, Jim Clifford, led Council's discussion of the January 4, 2021 regular meeting agenda.

ITEM 2. FINANCE: Capital Project Sales Tax I – Council Discussion

Jim Clifford, City Administrator, led Council in a discussion of the project and funding list of Capital Project Sales Tax I. (See ATTACHMENT #2A) A balance of approximately \$112,000 remains. Tom Zeaser, Director of Engineering and Public Works, has suggested using those funds to replace the wooden structure bridge that was built on the Greenway in 1998 near the Bark Park. He recommends a steel bridge with a concrete deck which would require little to no maintenance over the life of the bridge. (See ATTACHMENT #2B) Based on Council's comments and discussion, Mr. Clifford will ask staff to continue to invest time in vetting this option and return with more specific information for Council's consideration

ITEM 3. ENGINEERING AND PUBLIC WORKS: LED Lighting – Council Discussion

Scott Neely, Dominion Energy South Carolina, briefed Council on the potential use of LED lighting in the City. In his presentation Mr. Neely compared the current light sources with the proposed LED lighting highlighting the advantages of the newer technology. Dominion Energy is currently offering an incentive contract to reduce the City's LED monthly cost. Council reacted affirmatively to the possibility. Concern was expressed due to Downtown and neighborhood decorative street lighting not benefiting with the proposed contract. Jim Clifford, City Administrator, will continue to seek follow-up information about the decorative streetlights.

The study session adjourned at 7:01 pm.

APPROVED THIS 1 DAY OF
Feb, 2021.

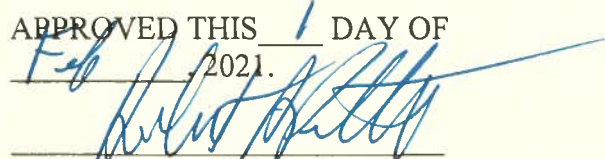
Robert A. Pettit, Mayor

Respectfully submitted,

Sharon Lamar
City Clerk

Chesterfield Street (Richland Avenue to Hampton Avenue)
 Abbeville Avenue (York Street to Sumter Street)
 York Street (Park Avenue to South Boundary Avenue)
 Laurens Street (Park Avenue to South Boundary Avenue)
 Valley Road (Richland Avenue intersection)

\$900,000 for construction of the Aiken Center for the Performing Arts
 \$400,000 for construction of Public Safety Station #5
 \$7,651,740 for the construction of recreational facilities

3. \$7,522,905 for the following projects within the City of North Augusta with estimated costs:

\$150,000 for expansion of the Recycling Center
 \$760,000 for Riverview Park improvements
 \$130,000 for completion of Summerfield Park
 \$80,000 for development of Walnut Lane Park
 \$1,600,000 for the reconstruction of various city streets
 \$850,000 for resurfacing city streets
 \$1,100,000 for improvements to city drainage systems
 \$752,905 for construction of sidewalks
 \$1,500,000 for development of the Greenway Extension
 \$600,000 for development of the Downtown

4. \$451,466 for the following projects in the City of New Ellenton with estimated costs:

\$435,000 for the construction of a new Civic Center to house police, fire, city and community functions
 \$16,466 for the paving of Evans Field walking track

5. \$327,874 for the following projects in the Town of Wagener with estimated costs:

\$80,000 for the renovation of the Downtown Pavilion
 \$220,000 for improvements to the Staley Road Sewer System
 \$22,000 for the purchase of a new police car
 \$5,874 for beautification project for Seivern Road

6. \$299,584 for the following projects in the Town of Jackson with estimated costs:

\$139,584 for improvements to the Town Hall and Community Center
 \$50,000 towards the purchase of a new fire truck
 \$50,000 for improvements and lighting for the Town Park and baseball field
 \$35,000 for landscaping projects for Highway 125 and Main Street
 \$25,000 for the purchase of a tractor and related equipment for landscaping maintenance work

7. \$72,030 for the following projects in the Town of Salley with estimated costs:

\$6,000 for upgrading the tennis court
 \$600 for upgrading the basketball court
 \$25,000 for development of a walking track
 \$9,030 for renovation of the Town Hall
 \$31,400 for construction of permanent public restrooms

8. \$67,831 for the following projects in the Town of Burnetown with estimated costs:

\$4,831 for the construction of sidewalks



EXPRESS Connector®

Albuquerque, NM

BRIDGE SUMMARY
 Connector Pedestrian Bridge 70' Span x 12' Width
 Deck Type: Concrete
 Bridge Finish: Weathering Steel

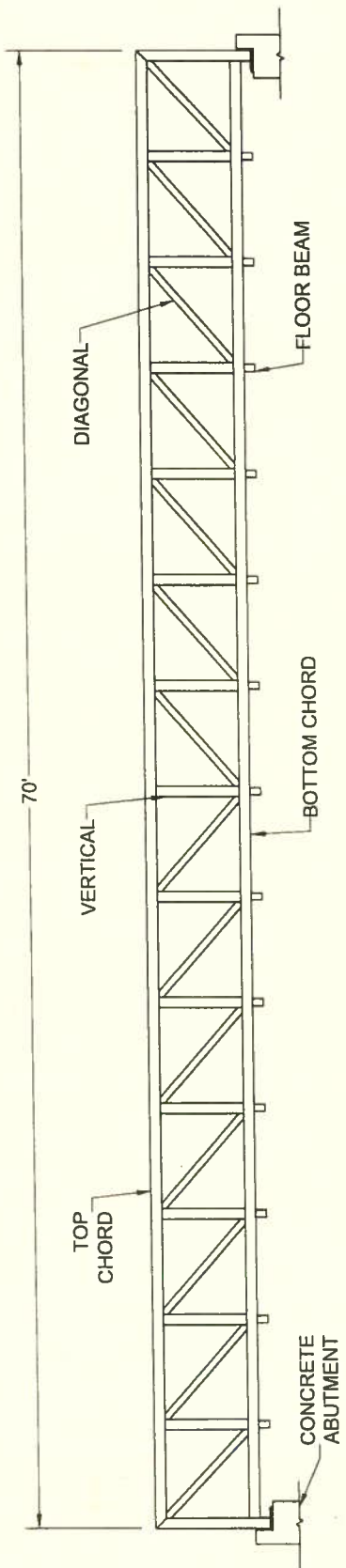

BRIDGE ELEVATION

The graphic information and details contained in these plans is schematic in nature. The plans, elevations and sections have been developed automatically in a way that demonstrates your current input in a relative and proportional manner. The details included in these plans have been selected to represent commonly built construction assemblies. These are not Engineering drawings, and as such, the details may vary in the final design for your project depending on many variables that are selected in your final scope of work and specifications.

CONTECH
 ENGINEERED SOLUTIONS LLC
 www.conteches.com
 9025 Centre Pointe Dr., Suite 400, West Chester, OH 45069
 606-338-1122 513-645-7000 513-645-7953 FAX

CONTINENTAL
 BRIDGE
 CONTECH
 DYOB
 DRAWING

Connector® 70' Span x 12' Width
 Waterworks Park Greenway Bridge
 Pedestrian Bridge
 North Augusta, South Carolina

PRELIMINARY NOT FOR CONSTRUCTION	
PROJECT NUMBER: 145186	DATE: 8/17/2018
DESIGNED: DYOB	DRAWN: DYOB
CHECKED: DYOB	APPROVED: [Signature]
SHEET NO.: 1	OF 4

MARK	DATE	REVISION DESCRIPTION	BY

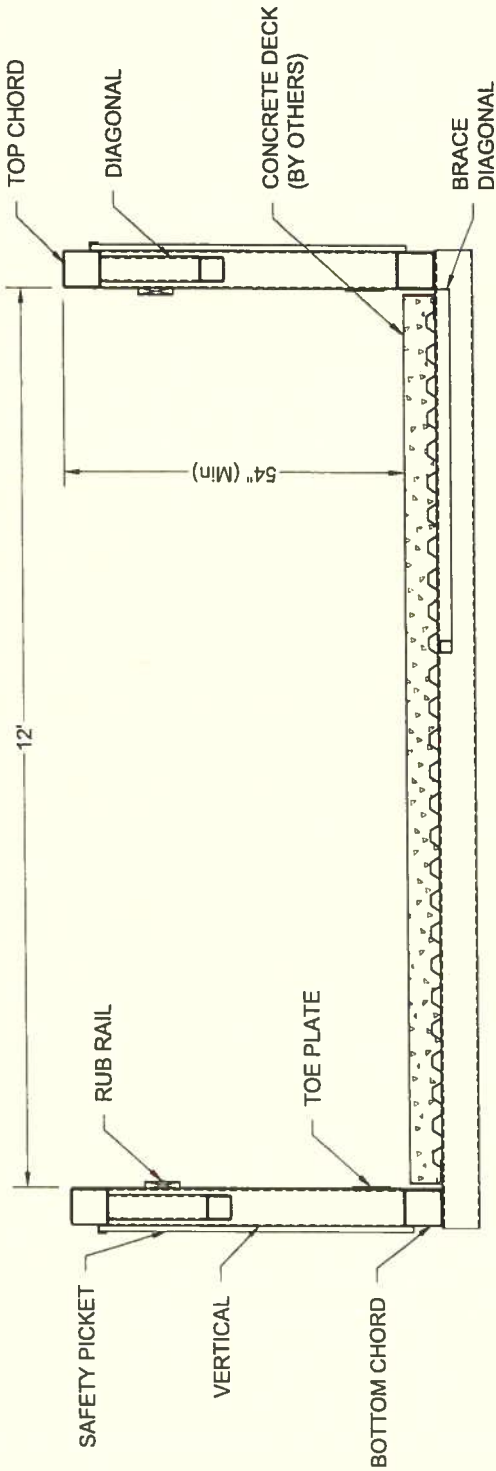

SECTION

The graphic information and details contained in these plans is schematic in nature. The plans, elevations and sections have been developed automatically in a way that demonstrates your current input in a relative and proportional manner. The details included in these plans have been selected to represent commonly built construction assemblies. These are not Engineering drawings, and as such, the details may vary in the final design for your project depending on many variables that are selected in your final scope of work and specifications.

CONTECH
ENGINEERED SOLUTIONS LLC
www.conteches.com
9025 Centre Pointe Dr., Suite 400, West Chester, OH 45088
600-338-1122 513-645-7000 513-645-7993 FAX

CONTINENTAL
BRIDGE
CONTECH
DYOB®
DRAWING

Connector® 70' Span x 12' Width
Waterworks Park Greenway Bridge
Pedestrian Bridge
North Augusta, South Carolina

PRELIMINARY NOT FOR CONSTRUCTION		PROJECT NUMBER	DATE
DESIGNED	DYOB	145186	01/17/2018
CHECKED	APPROVED		
PROJECT NO	3	of	4

MARK	DATE	REVISION DESCRIPTION	BY

Copyright © 2018 Contech Engineered Solutions LLC. All rights reserved. This drawing is the property of Contech Engineered Solutions LLC. It is to be used only for the project and location specified. No part of this drawing may be reproduced, stored in a retrieval system, or transmitted in any form or by any means, electronic, mechanical, photocopying, recording, or by any information storage and retrieval system, without the prior written permission of Contech Engineered Solutions LLC. Contech Engineered Solutions LLC is not responsible for any errors or omissions in this drawing. Contech Engineered Solutions LLC is not a contractor and does not provide construction services. Contech Engineered Solutions LLC is not a structural engineer and does not provide engineering services. Contech Engineered Solutions LLC is not a professional engineer and does not provide engineering services. Contech Engineered Solutions LLC is not a professional architect and does not provide architectural services. Contech Engineered Solutions LLC is not a professional landscape architect and does not provide landscape architectural services. Contech Engineered Solutions LLC is not a professional interior designer and does not provide interior design services. Contech Engineered Solutions LLC is not a professional graphic designer and does not provide graphic design services. Contech Engineered Solutions LLC is not a professional copywriter and does not provide copywriting services. Contech Engineered Solutions LLC is not a professional content creator and does not provide content creation services. Contech Engineered Solutions LLC is not a professional social media manager and does not provide social media management services. Contech Engineered Solutions LLC is not a professional public relations specialist and does not provide public relations services. Contech Engineered Solutions LLC is not a professional marketing strategist and does not provide marketing services. Contech Engineered Solutions LLC is not a professional business development specialist and does not provide business development services. Contech Engineered Solutions LLC is not a professional sales representative and does not provide sales services. Contech Engineered Solutions LLC is not a professional customer service representative and does not provide customer service services. Contech Engineered Solutions LLC is not a professional human resources specialist and does not provide human resources services. Contech Engineered Solutions LLC is not a professional training and development specialist and does not provide training and development services. Contech Engineered Solutions LLC is not a professional organizational development specialist and does not provide organizational development services. Contech Engineered Solutions LLC is not a professional change management specialist and does not provide change management services. Contech Engineered Solutions LLC is not a professional project management specialist and does not provide project management services. Contech Engineered Solutions LLC is not a professional risk management specialist and does not provide risk management services. Contech Engineered Solutions LLC is not a professional quality management specialist and does not provide quality management services. Contech Engineered Solutions LLC is not a professional information management specialist and does not provide information management services. Contech Engineered Solutions LLC is not a professional knowledge management specialist and does not provide knowledge management services. Contech Engineered Solutions LLC is not a professional intellectual property specialist and does not provide intellectual property services. Contech Engineered Solutions LLC is not a professional legal specialist and does not provide legal services. Contech Engineered Solutions LLC is not a professional accounting specialist and does not provide accounting services. Contech Engineered Solutions LLC is not a professional financial specialist and does not provide financial services. Contech Engineered Solutions LLC is not a professional insurance specialist and does not provide insurance services. Contech Engineered Solutions LLC is not a professional real estate specialist and does not provide real estate services. Contech Engineered Solutions LLC is not a professional transportation specialist and does not provide transportation services. Contech Engineered Solutions LLC is not a professional utility specialist and does not provide utility services. Contech Engineered Solutions LLC is not a professional environmental specialist and does not provide environmental services. Contech Engineered Solutions LLC is not a professional energy specialist and does not provide energy services. Contech Engineered Solutions LLC is not a professional water specialist and does not provide water services. Contech Engineered Solutions LLC is not a professional waste management specialist and does not provide waste management services. Contech Engineered Solutions LLC is not a professional recycling specialist and does not provide recycling services. Contech Engineered Solutions LLC is not a professional sustainability specialist and does not provide sustainability services. Contech Engineered Solutions LLC is not a professional social responsibility specialist and does not provide social responsibility services. Contech Engineered Solutions LLC is not a professional corporate governance specialist and does not provide corporate governance services. Contech Engineered Solutions LLC is not a professional ethics specialist and does not provide ethics services. Contech Engineered Solutions LLC is not a professional compliance specialist and does not provide compliance services. Contech Engineered Solutions LLC is not a professional risk assessment specialist and does not provide risk assessment services. Contech Engineered Solutions LLC is not a professional risk mitigation specialist and does not provide risk mitigation services. Contech Engineered Solutions LLC is not a professional risk transfer specialist and does not provide risk transfer services. Contech Engineered Solutions LLC is not a professional risk avoidance specialist and does not provide risk avoidance services. Contech Engineered Solutions LLC is not a professional risk reduction specialist and does not provide risk reduction services. Contech Engineered Solutions LLC is not a professional risk elimination specialist and does not provide risk elimination services. Contech Engineered Solutions LLC is not a professional risk identification specialist and does not provide risk identification services. Contech Engineered Solutions LLC is not a professional risk analysis specialist and does not provide risk analysis services. Contech Engineered Solutions LLC is not a professional risk evaluation specialist and does not provide risk evaluation services. Contech Engineered Solutions LLC is not a professional risk monitoring specialist and does not provide risk monitoring services. Contech Engineered Solutions LLC is not a professional risk reporting specialist and does not provide risk reporting services. Contech Engineered Solutions LLC is not a professional risk communication specialist and does not provide risk communication services. Contech Engineered Solutions LLC is not a professional risk documentation specialist and does not provide risk documentation services. Contech Engineered Solutions LLC is not a professional risk review specialist and does not provide risk review services. Contech Engineered Solutions LLC is not a professional risk audit specialist and does not provide risk audit services. Contech Engineered Solutions LLC is not a professional risk assessment specialist and does not provide risk assessment services. Contech Engineered Solutions LLC is not a professional risk management specialist and does not provide risk management services. Contech Engineered Solutions LLC is not a professional risk consulting specialist and does not provide risk consulting services. Contech Engineered Solutions LLC is not a professional risk advisory specialist and does not provide risk advisory services. Contech Engineered Solutions LLC is not a professional risk assessment specialist and does not provide risk assessment services. Contech Engineered Solutions LLC is not a professional risk management specialist and does not provide risk management services. Contech Engineered Solutions LLC is not a professional risk consulting specialist and does not provide risk consulting services. Contech Engineered Solutions LLC is not a professional risk advisory specialist and does not provide risk advisory services.

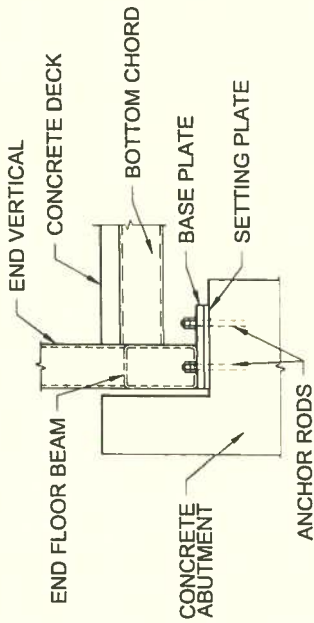

BEARING SIDE VIEW

INFORMATION PROVIDED FOR REPRESENTATION ONLY.
ACTUAL BEARING DIAGRAMS TO BE BASED ON FINAL DESIGN.

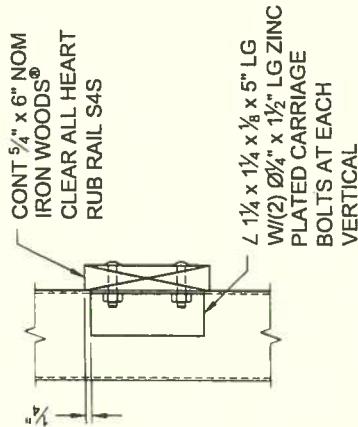

RUB RAIL DETAIL

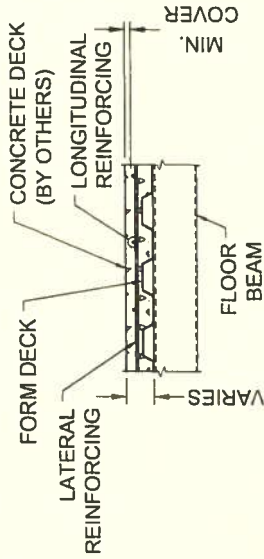

CONCRETE DECK REINFORCING

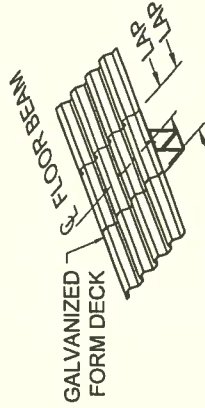

FORM DECK DETAIL

The graphic information and details contained in these plans is schematic in nature. The plans, elevations and sections have been developed automatically in a way that demonstrates your current input in a relative and proportional manner. The details included in these plans have been selected to represent commonly built construction assemblies. These are not Engineering drawings, and as such, the details may vary in the final design for your project depending on many variables that are selected in your final scope of work and specifications.

CONTECH
ENGINEERED SOLUTIONS LLC
www.contechES.com
9025 Centre Pointe Dr., Suite 400, West Chester, OH 45089
800-338-1122 513-645-7000 513-645-7993 FAX

CONTINENTAL
BRIDGE
CONTECH
DYOB®
DRAWING

Connector® 70' Span x 12' Width
Waterworks Park Greenway Bridge
Pedestrian Bridge
North Augusta, South Carolina

PROJECT NAME: 145186		DATE: 8/17/2018
DESIGNED: DYOB	DRAWN: DYOB	
CHECKED: APPROVED		
SHEET NO. 4		OF 4





Conversion Program HID to LED



SHEPHERD'S CROOK



CHARLESTON

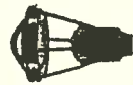

CONTEMPORARY



ROUND



OCTAGONAL



ACORN



TRADITIONAL

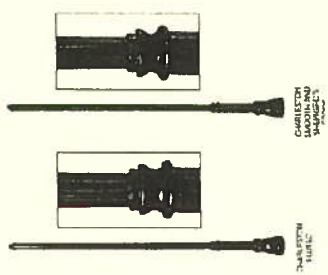
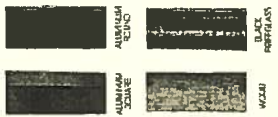

Conversion Program HID to LED

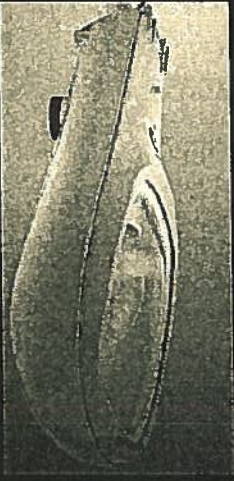

Background

- HID
 - High Pressure Sodium – Orange
 - Metal Halide – White
 - Mercury Vapor – Blue, Green
- LED
 - White light
- Differences in HID and LED Technologies
 - Bulb
 - Solid State
 - Discrete
 - Chip on Board

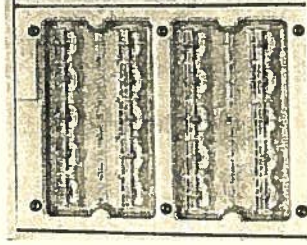
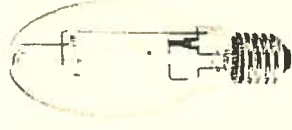

Uniformity (Less Shadows)

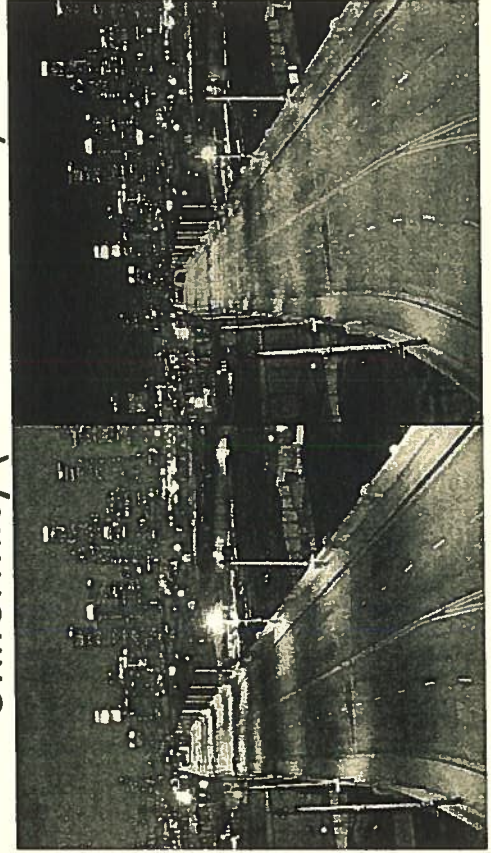

Uniformity (Light where you want it)

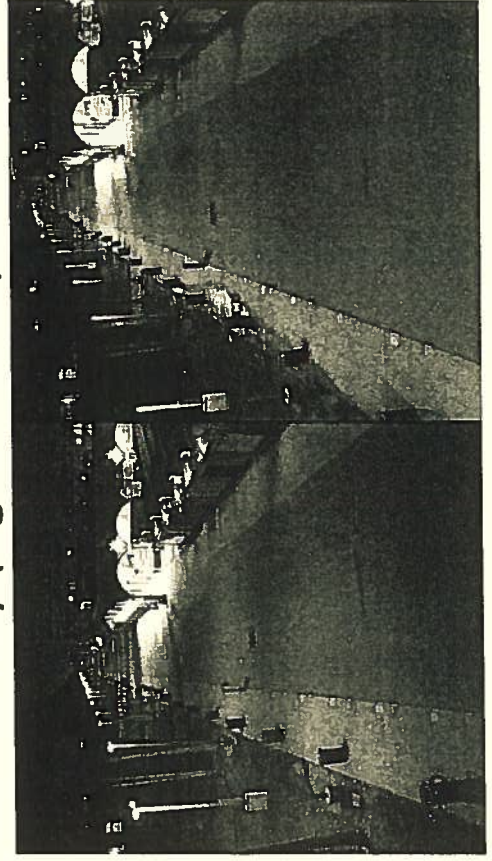

Color Impact

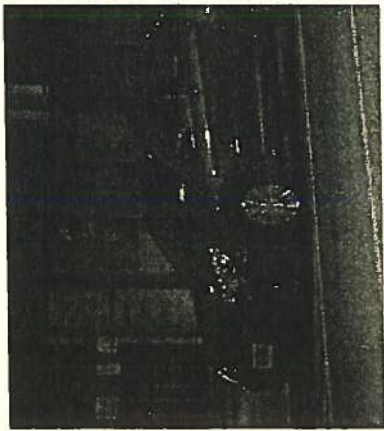

HPS Application

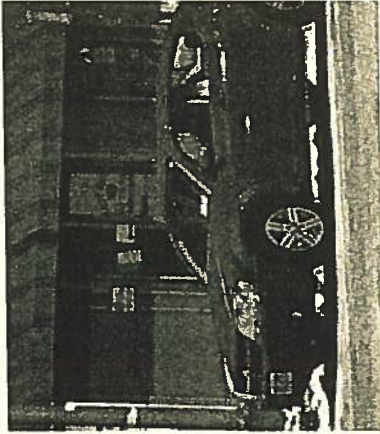

LED Application

Concept

- Need - Municipalities want to move to LED
- Issue - LED pricing still more expensive than HID
- Solution - LED conversion contract with incentives

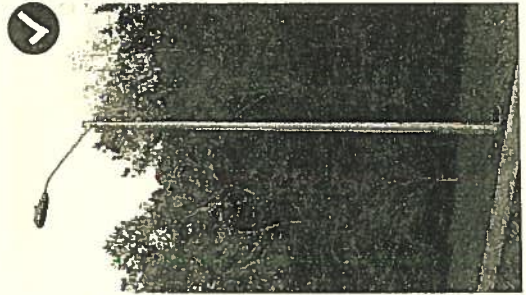

Eligible Fixtures

- Rate 17 - Municipal Street Lighting
 - Existing and New
 - OH fed on wooden poles
 - UG fed roadway
 - No decorative

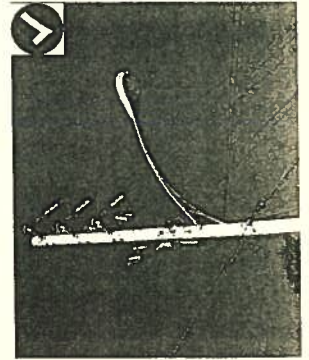

Contract Details

- 10-year contract
- 5-year incentive to reduce the LED monthly cost
- Incentive amounts at time of contract continue for life of contract
- Incentives may be lowered for future contracts
- Assumption - End of 5 years, LED non-incentive rate will be lower than HID - HID cost rising, LED steady or decreasing

Advantages

- Better quality lighting
 - Uniform (less shadows)
 - Color Impact closer to daylight
- No upfront charges
- At or below current total monthly cost
- Ability to add additional lighting at same monthly cost
- Communicating Node
 - Automatic notification of failure
 - Future – On/Off capabilities
 - Future – Dimming capabilities

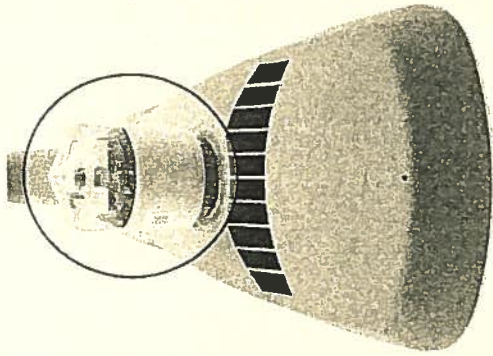

Customer: City of North Augusta
Date: 10/30/2020

Quantity	LED Light Fixture	Current LED Cost/Month	HID Light Fixture	Current HID Cost/Month	Wattage Savings (Per Fixture)	Incentive per Month (Per Fixture)	Incentive per Month (Total)	Net Customer Cost/Month	Savings per Month	Annual kWh Savings
148	ATB0 Grey 72w	\$ 1,826.32	175W AV OPEN	\$ 1,330.52	340	\$ 3.10	\$ 456.80	\$ 1,367.52	\$ 137.00	82,880
6	ATB0 Grey 72w	\$ 74.04	100W HPS OPEN	\$ 55.02	46	\$ 3.10	\$ 18.60	\$ 55.44	\$ (0.42)	1,104
781	ATB0 Grey 72w	\$ 9,637.54	150W HPS OPEN	\$ 7,864.67	99	\$ 3.10	\$ 2,421.10	\$ 7,216.34	\$ 643.23	305,276
44	ATB0 Grey 108w	\$ 221.12	150W HPS COBRA	\$ 164.66	99	\$ 3.10	\$ 55.80	\$ 166.32	\$ 18.36	7,128
243	ATB2 Grey 216w	\$ 601.48	250W HPS COBRA	\$ 659.48	185	\$ 0.52	\$ 22.88	\$ 578.60	\$ 110.88	32,560
48	ATB2 Grey 216w	\$ 4,877.01	360W HPS COBRA	\$ 4,182.03	203	\$ 4.33	\$ 1,052.13	\$ 3,824.82	\$ 357.21	197,316
14	ATB2 Grey 216w	\$ 953.36	400W AV CLSD OH	\$ 813.12	251	\$ 4.33	\$ 207.84	\$ 255.52	\$ 57.60	48,192
14	ATB2 Grey 216w	\$ 280.98	400W HPS COBRA	\$ 250.04	248	\$ 4.33	\$ 64.02	\$ 220.16	\$ 29.84	13,888
1302		\$ 18,483.85		\$ 15,369.56			\$ 4,297.83	\$ 14,185.02	\$ 1,184.54	692,344

Comparable Fixtures

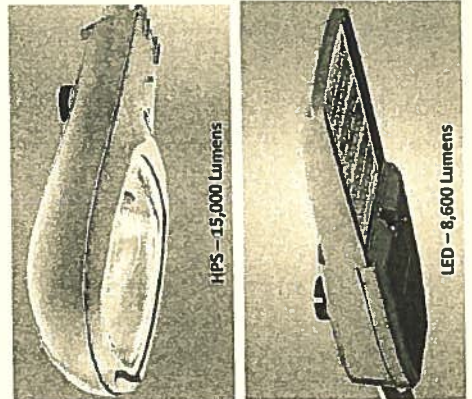

Comparable Fixtures

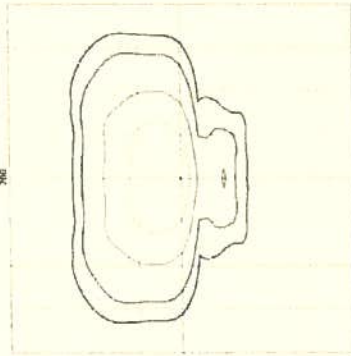
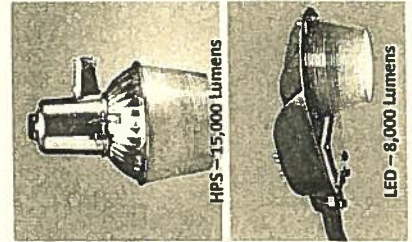

Roadway Pattern

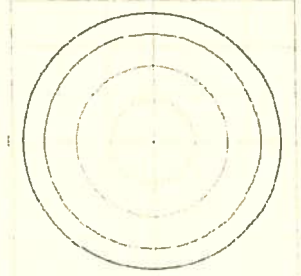

Private Light Pattern

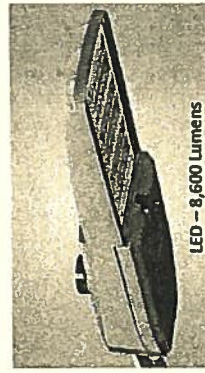

LED – 8,600 Lumens

Better – Roadway Pattern

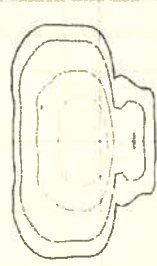

Deployment Details

- Getting contracts now
- Full deployment starting January 2021
- May take some months to get to you



Next Step

- Contract
- Identify any additional lights wanted
- Identify lumen increase areas



Rate 17 Conversion Questions?



New LED Projects

- Prepayment options available for Capital Dollars
- Extended Terms
- NSSF Money can be used for infrastructure

